

## Rectangular Buffers

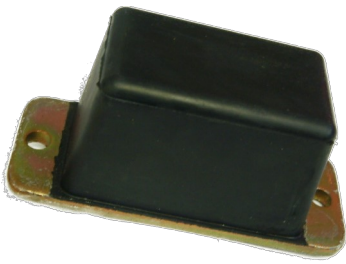

These parts are designed for impact protection. A range of sizes is available with many held in stock. Some styles are subject to minimum order quantities. Alternatively rectangular buffers can be manufactured from rail in a wide range of sizes.

### RECT-RB1099

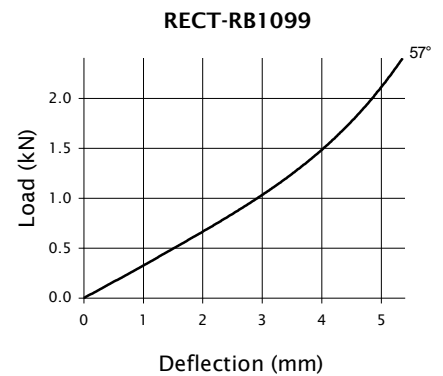
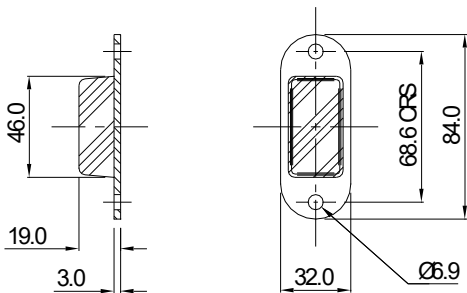

### RECT-RB1105

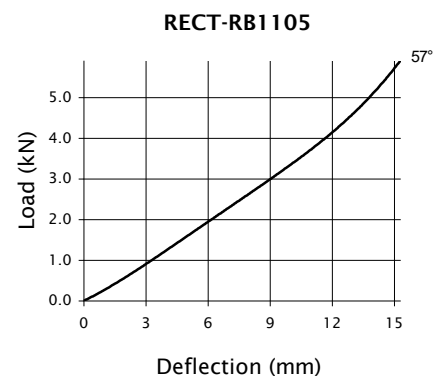
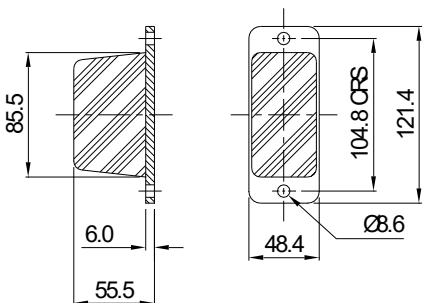

### RECT-RB1107

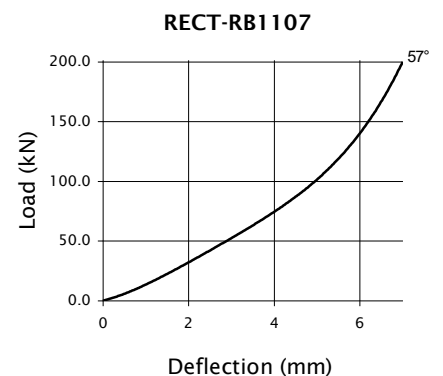
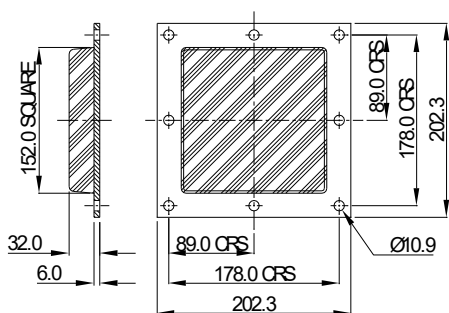

Note: There is a possible deviation of  $\pm 20\%$  in the above load/deflection graphs due to production and hardness tolerances

## RECT-RB1211

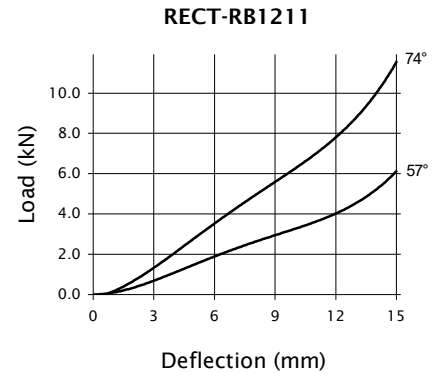
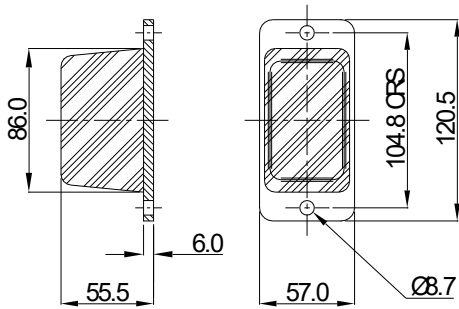

## RECT-RB1212

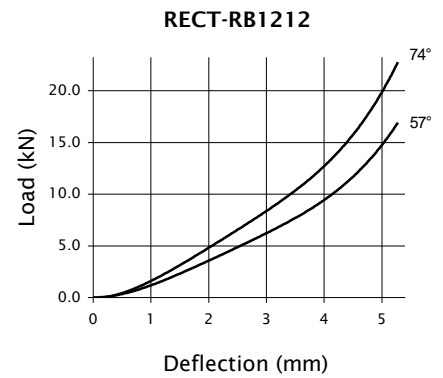
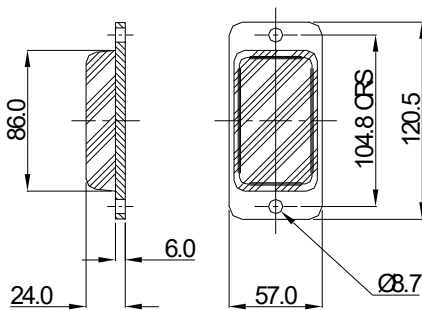

## RECT-RB1221

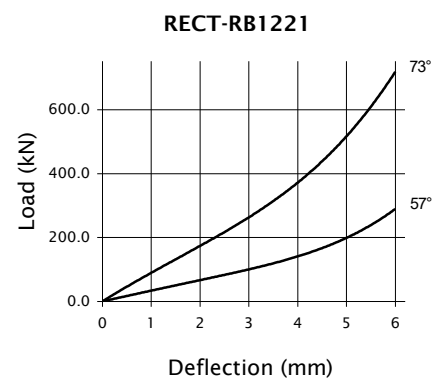
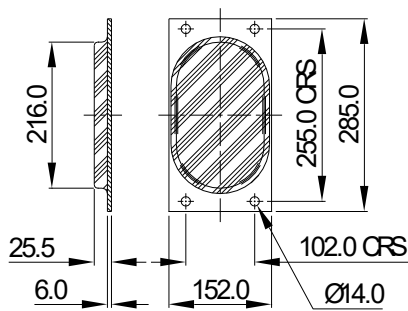

## RECT-RB1238

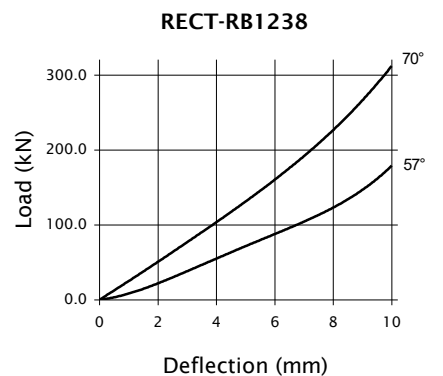
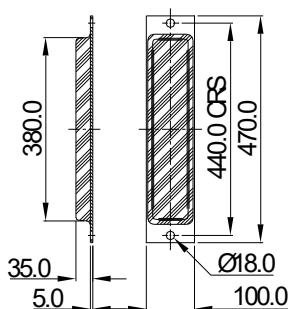

Note: There is a possible deviation of  $\pm 20\%$  in the above load/deflection graphs due to production and hardness tolerances

## Rectangular Buffers Cut From Rail

It is possible to manufacture Rectangular Buffers from Rail as illustrated. The rail can be supplied as manufactured in 2 metre lengths, or can be cut and drilled to meet the customer's individual requirement. This process has the added advantage that no tooling is normally required

